



**Republic of the Philippines**  
**Department of Education**  
 Region III – Central Luzon  
 Schools Division of Bulacan

**Request for Quotation (RFQ)**

**Date: February 11, 2026**  
**RFQ No.: Infra RFQ 2026 -02- 01**

**To all Eligible Suppliers:**

- I. Please quote your lowest price inclusive of VAT on the item listed on the following page, subject to the Terms and Conditions of this RFQ. Submit or send your quotation, fully sealed and duly signed by you or your representative to the Bids and Awards Committee or its Secretariat not later than **February 18, 10:00 am** at **DepEd - Schools Division Office Bulacan, Provincial Capitol Compound, Brgy. Guinhawa, City of Malolos**. Quotation that exceeds the approved budget for the contract (ABC) shall be rejected. For more information, email us at [procurement@bulacandeped.com.ph](mailto:procurement@bulacandeped.com.ph).

II.

  
**JAIME T. TUGADE, PhD, CESE, RGC**  
 BAC Chairperson  
 Infrastructure

**III. Particulars**

Lot No	Item & Description / Technical Specifications	Approved Budget for the Contract (ABC) in PhP	Quantity and Unit of Measure	Bidder's TOTAL PRICE in Pesos
	Repair and Improvement of Schools Division Office Building	<b>Php 670,385.22</b>	<b>See attached Program of Works</b>	

Contract Duration: **Thirty (30) days** from Contractor's receipt of Notice to Proceed.

Location/Site: **Capitol Compound, Brgy. Guinhawa, City of Malolos, Bulacan**

This is to submit our price quotations as indicated above subject to the terms and conditions of this RFQ.

Contractor's Business Name:				TIN:	
Address:					
Telephone No.:		Fax No.:		E-mail:	
Supplier's Authorized Representative's Signature over Printed Name:				Date:	

## Terms and Conditions

### A. Submission of Requirements

1. **Sealed quotations and other requirements stated below** shall be submitted or sent by the bidder/supplier to the Bids and Awards Committee (BAC) or its Secretariat on or before the deadline for submission quotation(s) and at the address stated in this RFQ, as follows:

- 1.1. Duly signed and accomplished Request for Quotation (prices quoted in Philippine currency)
- 1.2. Duly accomplished and signed Program of Works: Bill of Quantities and Detailed Cost Estimate;
- 1.3. Current Mayor's/Business Permit
- 1.4. Certificate of PhilGEPS Registration (Platinum)/PhilGEPS Registration Number
- 1.5. Income or Business Tax Return
- 1.6. PCAB License (General Building)
- 1.7. Omnibus Sworn Statement

Bidder's/supplier's failure to submit or send any of the above-stated documents on or before the deadline stated in this RFQ shall be ground for disqualification of the bidder/supplier and its/his/her/their quotation(s).

### B. Evaluation of Quotations

Quotations shall be compared and evaluated on the basis of the following criteria:

1. Completeness of Submission
2. Bidders' price quotations
3. Compliance with procuring entity's assessment of the technical, legal, and financial capability and experience of the bidder in the same or similar business

In case two or more bidders are determined to have submitted the Lowest Calculated Quotation/Lowest Calculated and Responsive Quotation, the procuring entity shall adopt and employ "draw lots" as the tie-breaking method to finally determine the single winning bidder in accordance with GPPB Circular 06-2005.



### C. Award

Bidder(s)/supplier(s) who submitted the lowest calculated and responsive quotation(s) shall be awarded the PO after evaluation of quotations by the BAC.

### D. Project Completion

1. Completion of the project shall be made within **30 calendar days** from date of receipt of Notice to Proceed by the Contractor.
2. The Project Site is at **Capitol Compound, Brgy. Guinhawa, City of Malolos, Bulacan.**
3. Upon completion of the project, the contractor shall notify the Procuring Entity and present the following documents:
  - a. Notice to Proceed;
  - b. Statement of Work Accomplishment;
  - c. Inspection/Punchlist of Corrective Works Report;
  - d. Progress Photographs (Before, During, After);
  - e. Certificate of Completion; and
  - f. Certificate of Turn-Over

For the purpose of these conditions, the procuring entity's representative at the Project Site is **Carl Paulo A. Fernando, Division Engineer.**

### E. Instructions

- a. Contractor shall be responsible for the source(s) of its materials/equipment, and shall perform the work/s in accordance with the schedule, and specifications of the project. Failure of the contractor to comply with this provision shall be ground for cancellation of the award or contract issued to the contractor.
- b. Contractor shall proceed with works of the project in its favor after the date of receipt of notice to that effect. A Notice to Proceed shall constitute an official notice to the Contractor. Thereafter, if the project has not yet started, the contract may be cancelled.
- c. Contractor who accepted a project but failed without justifiable cause to perform the work within the time called for in the contract shall be disqualified from participating in DepEd or any of DepEd units' future procurement activities. This is without prejudice to the imposition of other sanctions prescribed under R.A. 9184 and its revised IRR against the supplier.

The term "without justifiable cause" refers to force majeure, and/or extraordinary circumstances defined in the Civil Code of the Philippines.

- d. Rejected work shall be construed as non-delivery, and the contractor shall undertake the necessary repair works, at his own expense, subject to liquidated damages for delayed completion.
- e. All duties, revenue charges, excise and other taxes shall be paid by the Contractor.
- f. All transactions are subject to withholding of credible Value Added Tax and/or Expanded Value Added Tax per revenue regulation(s) of the Bureau

of Internal Revenue.

## **F. Inspection**

1. The Procuring Entity may conduct an inspection prior to the award of Contract, to validate compliance to the required technical requirements.
2. All work accomplished by the contractor shall be subjected to inspection, and acceptance by the DepEd Inspection team and end-user.

For the purpose of this condition, the Procuring Entity's representative at Project Site is Carl Paulo A. Fernando, Division Engineer.

## **G. Liquidated Damages**

A penalty of one-tenth of one per cent (0.1%) of the cost of the unperformed portion of the works for every day of delay shall be charged to defaulting contractor.

## **H. Warranty**

One (1) year from project completion up to final acceptance or the defects liability period, the contractor shall undertake repair works, at his own expense, of any damage to the infrastructure on account of the use of materials of inferior quality, within thirty (30) days from the time the Head of the Procuring Entity has issued an order to undertake repair.

In case the bidder/supplier fails to comply with its obligation under this warranty, the procuring entity may exercise its option to blacklist the contractor in accordance with the provisions of RA 9184 and its revised IRR.

To signify said warranty, the bidder/supplier shall issue a Warranty Certificate in favor of the procuring entity as a condition for payment of the contract price.

## **I. Payment**

1. Partial payment can be made thru progress billing of the works accomplished and submission by the contractor of the following documents:
  - a. Request for Payment;
  - b. Statement of Work Accomplished; and
  - c. Progress Photographs of accomplished works;
2. Full and final payment shall be made upon full completion of the works and submission by the contractor of the following documents:
  - a. Request for Final Payment;
  - b. Statement of Work Accomplished;
  - c. Inspection/Punchlist of Corrective Works Report;
  - d. Progress photographs;
  - e. Certificate of Completion; and
  - f. Certificate of Turn-Over Acceptance;



### **J. Reservation Clause**

The procuring entity reserves the right to reject any and/or all quotations, not award the contract or annul the bidding process under the following situations without thereby incurring any liability to the affected parties or bidders:

- a) If there is prima facie evidence of collusion between appropriate public officers or employees of the procuring entity, or between the BAC and any of the bidders, or if the collusion is between or among the bidders themselves, or between a bidder and a third party, including any act which restricts, suppresses or nullifies or tends to restrict, suppress or nullify competition;
- b) If the BAC is found to have failed in following the prescribed bidding procedures; or
- c) For any justifiable and reasonable ground where the award of the contract will not redound to the benefit of the GOP, as follows;
- d) if the physical and economic conditions have significantly changed so as to render the project no longer economically, financially, or technically feasible, as determined by the Head of the Procuring Entity;
- e) if the project is no longer necessary as determined by the Head of the Procuring Entity; and
- f) if the source of funds for the project has been withheld or reduced through no fault of the procuring entity.

### **K. Bidder's binding commitment to the procuring entity**

After having carefully read and accepted your Request for Quotation (RFQ) and its Terms and Conditions, I/We submit herein price quotation(s) for the item(s) in this RFQ. The quotation(s) shall be binding upon me/us for **thirty (30) calendar days** reckoned from last day of submission indicated in this RFQ. The corresponding Award or Contract shall be accepted by me/us at any time before expiration of this period.

I/We confirm that the prices quoted in this RFQ are fixed and firm for the duration of the validity period and will not be subject to upward revision or variation.

We confirm that we are eligible to participate in government public procurements having been issued valid business permit, license, and/or registration by the government and/or its instrumentalities.

My/our authorized signature on page two (2) of this RFQ binds me/us to this document of the procuring entity.



Republic of the Philippines  
Department of Education

Region III  
SCHOOLS DIVISION OF BULACAN

**PROGRAM OF WORKS**  
**BILL OF QUANTITIES / SUMMARY SHEET**

Office: SCHOOLS DIVISION OFFICE OF BULACAN			Date: February 2026			
Region: III			Budget Allocation: PHP 670,385.22			
Division: BULACAN			Engineering and Admin Overhead: PHP 0.00			
Project Title:  REPAIR AND IMPROVEMENT OF SCHOOLS DIVISION OFFICE BUILDING			Approved Budget for Contract: PHP 670,385.22			
			Completion Period: 30 calendar days			
			Minimum Required Manpower:			
			General Foreman	Welder	Carpenter	Electrician
			Helper	Mason	Painter	
Location: Capitol Compound, Guinhawa, City of Malolos, Bulacan			Minimum Required Equipment:			
			Hand Tools	Welding Machine		
			One-Bagger Mixer	Bar Cutter		
Item I.D.	Item Description	% of Total	Unit	Quantity	Total Cost	Remarks
1	I. General Requirements	1.49%	lot	1.00	P 10,000.00	
	Sub-Total				10,000.00	
	II. DIRECT COST					
1.0	Earthworks Works	0.62%	cu.m	6.00	4,149.12	-ASDS Quarters
2.0	Concreting Works	1.96%	cu.m	1.97	13,148.96	-Procurement Office
3.0	Rebar Works	0.50%	kg	57.04	3,363.65	-Conference Room Accordion
4.0	Formworks	0.22%	sq.m	1.08	1,484.19	Partition repair
5.0	Masonry Works	6.05%	sq.m	56.64	40,549.04	-Water Supply Bladder Tank replacement
6.0	Doors and Windows	7.08%	lot	1.00	47,448.98	-Roof Gutter repair of 3rd Floor -
8.0	Roofing Works	1.47%	lot	1.00	9,841.71	Comfort Rooms
9.0	Ceiling and Carpentry Works	10.27%	sq.m	9.25	68,842.20	-Ceiling replacement of 3rd Floor
10.0	Electrical Works	7.94%	lot	1.00	53,202.42	Comfor Rooms
11.0	Plumbing Works	14.78%	lot	1.00	99,065.22	-Additional faucet on ground floor
12.0	Sanitary Works	2.74%	lot	1.00	18,343.72	- Replacement of sanitary
13.0	Painting Works	5.03%	sq.m	158.07	33,744.16	drainage piping of 12 lavatories
14.0	Tile Works	22.87%	sq.m	74.31	153,305.44	
	Sub-Total				546,488.79	
	III. INDIRECT COST 15% of (II)					
	Overhead Expenses (5%)	4.08%			27,324.44	
	Contractor's Profit (10%)	8.15%			54,648.88	
	Sub-Total				81,973.32	
	IV. TAX 5% of (I+II+III)					
	Sub-Total	4.76%			31,923.11	
	V. TOTAL CONSTRUCTION COST (I + II + III+IV)	100.00%			670,385.22	

Prepared by:

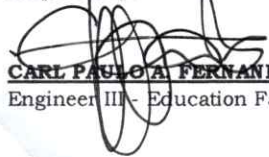
  
**CARL PAULO A. FERNANDO**  
Engineer III - Education Facilities

Recommending Approval:

  
**RAINELDA M. BLANCO, PhD**  
Chief Education Supervisor - SGOD

Reviewed by:

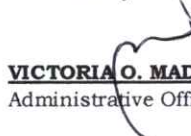
  
**VICTORIA O. MADRIGAL**  
Administrative Officer V

Approved:

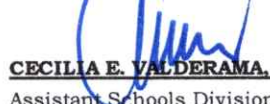
  
**CECILIA E. VALDERAMA, PhD, CESO VI**  
Assistant Schools Division Superintendent  
Officer-in-Charge  
Office of the Schools Division Superintendent





Republic of the Philippines  
**Department of Education**  
Region III  
SCHOOLS DIVISION OF BULACAN

**PROGRAM OF WORKS**  
**DETAILED COST ESTIMATE**

PROJECT : REPAIR AND IMPROVEMENT OF SCHOOLS DIVISION OFFICE BUILDING  
SCHOOL : SCHOOLS DIVISION OFFICE OF BULACAN  
LOCATION : Capitol Compound, Guinhawa, City of Malolos, Bulacan  
OWNER : DEPARTMENT OF EDUCATION

ITEM NO.	DESCRIPTION	UNIT	QTY	UNIT COST	TOTAL COST
<b>GENERAL REQUIREMENTS</b>					
	Mobilization / Demobilization	lot	1.00	5,000.00	10,000.00
<b>1.0000</b>	<b>Earthworks</b>				<b>10,000.00</b>
	<b>Sub-total</b>				
	<b>Labor</b>				
1.0400	Excavation, Medium	cu.m	6.00	691.52	4,149.12
	<b>Sub-total</b>				<b>4,149.12</b>
<b>2.0000</b>	<b>Concreting Works</b>				
	<b>Materials</b>				
2.0200	Portland Cement	bag	18.00	205.00	3,690.00
2.0300	Crushed Gravel 3/4"	cu.m	2.00	1,600.00	3,200.00
2.0500	Washed Sand	cu.m	2.00	1,200.00	2,400.00
	<b>Labor</b>				
2.0100	Demolition - Slab/Pavement (Manual)	cu.m	1.88	345.76	650.03
2.0700	Concrete Pouring - Grade Level (Manual)	cu.m	1.97	1,628.90	3,208.93
	<b>Sub-total</b>				<b>13,148.96</b>
<b>3.0000</b>	<b>Rebar Works</b>				
	<b>Materials</b>				
3.1000	D10mm x 6.00 mts RSB	pc	16.00	150.00	2,400.00
3.1200	G.I. Tie Wire	kg	2.00	80.00	160.00
	<b>Labor</b>				
3.0200	Rebar - Grade Level	kg	57.04	14.09	803.65
	<b>Sub-total</b>				<b>3,363.65</b>
<b>4.0000</b>	<b>Formworks</b>				
	<b>Materials</b>				
4.0100	Coco Lumber	sq.m	1.08		
4.0200	Plywood Ordinary, 1/4" x 4' x 8'	bd.ft	19.00	35.00	665.00
4.0400	CWN, Assorted	pc	1.00	420.00	420.00
	<b>Labor</b>				
4.0900	Installation - Suspended Slab Forms + Shoring	kg	1.00	90.00	90.00
4.1000	Dismantling - Suspended Slab/Beam Forms	sq.m	1.08	139.50	150.66
4.1100	Dismantling - Shoring	sq.m	1.08	97.32	105.11
	<b>Sub-total</b>				<b>1,484.19</b>
<b>5.0000</b>	<b>Masonry Works</b>				
	<b>Materials</b>				
	Masonry Wall	sq.m	28.32		
5.0300	CHB 4" thk	pc	354.00	16.00	5,664.00
2.0200	Portland Cement	bag	15.00	205.00	3,075.00
2.0500	Washed Sand	cu.m	2.00	1,200.00	2,400.00
5.0400	10mm x 6m RSB	kg	38.00	40.36	1,533.59
3.1200	G.I. Tie Wire	kg	1.00	80.00	80.00
	<b>Plastering</b>				
2.0200	Portland Cement	sq.m	56.64		
2.0500	Washed Sand	bag	19.00	205.00	3,895.00
	<b>Labor</b>				
5.0100	CHB Laying	cu.m	2.00	1,200.00	2,400.00
5.0300	Plain Cement Wall Finish	sq.m	28.32	189.45	5,365.28
	<b>Sub-total</b>				<b>40,549.04</b>
<b>6.0000</b>	<b>Doors and Windows</b>				
	<b>Materials</b>				
6.0500	PVC Door	sq.m	2.52	1,800.00	4,536.00



ITEM NO.	DESCRIPTION	UNIT	QTY	UNIT COST	TOTAL COST
6.1600	Entrance, Lockset Standard	set	2.00	750.00	1,500.00
6.2000	Hinges, Standard 3-1/2" x 3-1/2"	pa	6.00	180.00	1,080.00
6.1300	Sliding Aluminum Window	sq.m	2.40	5,500.00	13,200.00
6.1500	Security Grilles	sq.ft	25.82	110.00	2,840.22
	Repair of Accordion Glass Partition	lot	1.00	15,000.00	15,000.00
	<b>Labor</b>				
6.0100	Installation - Door, Jamb + Hardware	set	4.00	1,587.60	6,350.40
6.0400	Installation - Sliding Glass Door/Windows	sq.m	2.40	1,225.98	2,942.36
	<b>Sub-total</b>				<b>47,448.98</b>
<b>8.0000</b>	<b>Roofing Works</b>				
	<b>Materials</b>				
8.0800	Stainless 304 Gutter, Preformed, 0.610m x 2.440m x 0.4mm	pc	6.00	950.00	5,700.00
9.2200	Concrete Nails	kg	1.00	80.00	80.00
8.1100	Blind Rivets	pc	90.00	1.35	121.50
8.1300	Roof Sealant	L	2.00	475.00	950.00
	<b>Labor</b>				
8.0200	Installation - GI Bended Accessories	lm	14.40	207.65	2,990.21
	<b>Sub-total</b>				<b>9,841.71</b>
<b>9.0000</b>	<b>Ceiling and Carpentry Works</b>				
	<b>Materials</b>	<b>sq.m</b>	<b>9.25</b>		
9.1000	Metal Double Furring Channel (19mm x 50mm x 3m x 0.5mm thk)	pc	19.00	122.00	2,318.00
9.0800	Metal Carrying Channel (12mm x 38mm x 5m x 0.8mm thk)	pc	6.00	140.50	843.00
9.1100	Wall Angle 1" x 1" x 10'	pc	10.00	51.00	510.00
9.1200	Preformed Wire Clip	pc	50.00	5.00	250.00
9.1300	Rod Suspension Hanger with Adjustment Spring	pc	10.00	135.00	1,350.00
9.2200	Concrete Nails	kg	1.00	80.00	80.00
8.1100	Blind Rivets	pc	320.00	1.35	432.00
9.0900	Fiber Cement Ceiling Board (4.5mm thk)	pc	4.00	480.00	1,920.00
	Metal Studs (35mm x 76mm x 3m x 0.5mm thk)	pc	12.00	245.00	2,940.00
	Metal Tracks (35mm x 76mm x 3m x 0.5mm thk)	pc	8.00	210.00	1,680.00
9.0890	Fiber Cement Board, 1/4" x 4' x 8'	pc	10.00	660.00	6,600.00
	Rockwool Insulation (50mm x 0.6m x 50m)	roll	2.00	1,500.00	3,000.00
	Overhead/Base Kitchen Cabinet (1.5m x 0.8m x 0.3m)	set	2.00	20,000.00	40,000.00
	<b>Labor</b>				
9.0100	Light Metal Wall Studs	sq.m	11.76	183.75	2,160.90
9.0200	Cement Fiber Partition Boards (one side)	sq.m	23.52	98.92	2,326.60
9.0300	Installation - Ceiling Joists	sq.m	9.25	183.75	1,699.69
9.0400	Installation - Ceiling Boards	sq.m	9.25	79.14	732.01
	<b>Sub-total</b>				<b>68,842.20</b>
<b>10.0000</b>	<b>Electrical Works</b>				
	<b>Materials</b>				
	<i>Roughing Ins</i>				
10.0100	Electrical Conduit uPVC, 15mmØ	pc	50.00	105.00	5,250.00
10.1200	Junction Box, 4" x 4" G.I.	pc	5.00	80.00	400.00
10.1300	Utility Box, 2" x 4" G.I.	pc	13.00	80.00	1,040.00
	<i>Wires and Fixtures</i>				
10.1600	3.5 mm² THHN Wire, Stranded	m	300.00	27.50	8,250.00
10.1700	5.5 mm² THHN Wire, Stranded	m	100.00	42.00	4,200.00
10.2700	Duplex Convenience Outlet, Grounding Type, 20A, 250V	set	9.00	263.80	2,374.20
10.3010	Aircon Outlet with Plate	pc	2.00	282.75	565.50
10.3310	Safety Switch 30A 2P	set	2.00	603.25	1,206.50
10.3100	2 Single Pole Wall Switches in One Switch Plate (10 AMP, 230V)	set	2.00	160.00	320.00
10.2900	Single Pole Wall Switch in One Switch Plate (10 AMP, 230V)	set	2.00	105.00	210.00
10.3600	LED Downlight surface mounted	set	8.00	490.00	3,920.00
10.3400	2 - 28W, 230V, 60Hz, AC Fluorescent Lighting Fixture, (Box Type)	set	5.00	2,600.00	13,000.00
10.5500	Electrical Tape	pc	2.00	37.50	75.00
	<b>Labor</b>				
10.0100	Installation - PVC Flexible Conduit+Boxes, 15-25mmØ	lm	150.00	19.53	2,929.12
10.0800	Installation - Switches/CO/Outlets	ea	20.00	198.45	3,969.00
10.1000	Installation - Wires & Cables	lm	400.00	9.76	3,905.50
10.1100	Testing & Commissioning	ea	1.00	1,587.60	1,587.60
	<b>Sub-total</b>				<b>53,202.42</b>
<b>11.0000</b>	<b>Plumbing Works</b>				
	<b>Materials</b>				
11.0200	Water Closet 1.6gpf with Accessories	set	2.00	5,500.00	11,000.00
11.0100	Water Closet Flange	set	2.00	262.50	525.00



ITEM NO.	DESCRIPTION	UNIT	QTY	UNIT COST	TOTAL COST
11.0600	Lavatory, Pedestal Type with Accessories	set	2.00	2,100.00	4,200.00
11.0400	Kitchen Sink, Stainless with drain board, Complete Accessories	set	1.00	3,500.00	3,500.00
11.0410	Faucet, Lavatory	set	1.00	800.00	800.00
11.0510	Faucet	set	3.00	705.80	2,117.40
11.0510	Telephone Shower	set	1.00	2,000.00	2,000.00
11.1000	PP-R Pipe 3/4"Ø x 4.0m	pc	15.00	464.00	6,960.00
11.1500	PP-R Coupling, 3/4"Ø	pc	15.00	16.00	240.00
11.2600	PP-R Tee, 3/4"Ø	pc	15.00	23.00	345.00
11.2100	PP-R Elbow 90° x 3/4"Ø	pc	5.00	19.00	95.00
11.1100	PP-R Pipe 1/2"Ø x 4.0m	pc	5.00	297.00	1,485.00
11.1600	PP-R Coupling, 1/2"Ø	pc	5.00	11.00	55.00
11.2700	PP-R Tee, 1/2"Ø	pc	5.00	16.00	80.00
11.2200	PP-R Elbow 90° x 1/2"Ø	pc	5.00	16.00	80.00
11.1710	PP-R Coupling Reducer, 3/4" x 1/2"Ø	pc	5.00	16.00	80.00
11.2220	PP-R Elbow Reducer, 3/4" x 1/2"Ø	pc	5.00	23.00	115.00
11.3800	Gate Valve, 3/4"Ø	pc	2.00	415.00	830.00
	PP-R Adaptor Female Thread 1/2"Ø	pc	5.00	120.00	600.00
11.4410	S.S. Floor Drain 4" x 4"	set	2.00	97.50	195.00
	Bladder Tank, 750 liters	set	1.00	50,000.00	50,000.00
11.4410	S.S. Floor Drain 4" x 4"	set	2.00	97.50	195.00
11.4410	S.S. Floor Drain 4" x 4"	set	1.00	97.50	97.50
11.4410	S.S. Floor Drain 4" x 4"	set	1.00	97.50	97.50
11.4410	S.S. Floor Drain 4" x 4"	set	3.00	97.50	292.50
	<b>Labor</b>				
11.0200	Installation - PPR Pipe 12-38mmØ	lm	80.00	63.50	5,080.32
	Installation - Plumbing Fixtures	ea	8.00	1,000.00	8,000.00
	<b>Sub-total</b>				<b>99,065.22</b>
<b>12.0000</b>	<b>Sanitary Works</b>				
	<b>Materials</b>				
12.0500	PVC Sanitary Pipe 4"Ø x 3.0m	pc	4.00	655.00	2,620.00
12.0900	PVC Sanitary Elbow 90° x 4"Ø	pc	4.00	96.00	384.00
12.1300	PVC Sanitary Elbow 1/8 x 4"Ø	pc	3.00	82.50	247.50
12.1600	PVC Sanitary Wye 4" x 4"	pc	5.00	165.00	825.00
12.2000	PVC Sanitary Wye Reducer 4" x 2"	pc	11.00	97.00	1,067.00
12.0700	PVC Sanitary Pipe 2"Ø x 3.0m	pc	9.00	285.00	2,565.00
12.1100	PVC Sanitary Elbow 90° x 2"Ø	pc	30.00	25.00	750.00
12.1410	PVC Sanitary Elbow 1/8 x 2"Ø	pc	30.00	20.50	615.00
12.2700	PVC P-Trap 2"	pc	2.00	66.00	132.00
12.2700	PVC P-Trap 2"	pc	2.00	66.00	132.00
12.3000	PVC Cement	can	5.00	150.00	750.00
12.2400	Brass Cleanout 4" x 4"	pc	2.00	350.00	700.00
	<b>Labor</b>				
11.0200	Installation - PPR Pipe 12-38mmØ	lm	56.00	63.50	3,556.22
	Installation - Plumbing Fixtures	ea	4.00	1,000.00	4,000.00
	<b>Sub-total</b>				<b>18,343.72</b>
<b>13.0000</b>	<b>Painting Works</b>				
	<b>Materials</b>				
	Concrete Surfaces	sq.m	108.00		
13.0200	Latex, Flat	gal	6.00	650.00	3,900.00
13.0300	Masonry Putty	gal	2.00	450.00	900.00
13.0400	Latex, Semi Gloss	gal	11.00	750.00	8,250.00
13.0500	Acrylic Color	qrt	5.00	200.00	1,000.00
	Wood Surfaces	sq.m	50.07		
13.0600	Enamel, Flatwall	gal	3.00	750.00	2,250.00
13.0700	Glazing Putty	gal	1.00	600.00	600.00
13.0800	Enamel, Semi Gloss	gal	6.00	760.00	4,560.00
13.0900	Paint Thinner	gal	3.00	380.00	1,140.00
	<b>Labor</b>				
13.0600	Ceiling painting (3 coats)	sq.m	38.31	79.38	3,041.05
13.0700	Wood painting (3 coat)	sq.m	11.76	105.84	1,244.68
13.0300	Wall painting (roller application, 3 coats)	sq.m	108.00	63.50	6,858.43
	<b>Sub-total</b>				<b>33,744.16</b>
<b>14.0000</b>	<b>Tile Works</b>				
	<b>Materials</b>				
	Room	sq.m	38.31		
14.0220	Unglazed Floor Tiles 60cm x 60cm	pc	112.00	310.00	34,720.00
14.0300	Tile Adhesive 25 kg/bag	bag	32.00	400.00	12,800.00
14.0500	Tile Grout 5 kg/bag	bag	3.00	200.00	600.00
2.0200	Portland Cement	bag	20.00	205.00	4,100.00
2.0500	Washed Sand	cu.m	3.00	1,200.00	3,600.00
	Comfor Room Flooring	sq.m	5.28		



ITEM NO.	DESCRIPTION	UNIT	QTY	UNIT COST	TOTAL COST
14.0220	Unglazed Floor Tiles 60cm x 60cm	pc	16.00	310.00	4,960.00
14.0300	Tile Adhesive 25 kg/bag	bag	5.00	400.00	2,000.00
14.0500	Tile Grout 5 kg/bag	bag	1.00	200.00	200.00
	Com for Room Walls	sq.m	30.72		
14.0120	Glazed Wall Tiles 60cm x 60cm	pc	88.00	300.00	26,400.00
14.0300	Tile Adhesive 25 kg/bag	bag	26.00	400.00	10,400.00
14.0500	Tile Grout 5 kg/bag	bag	3.00	200.00	600.00
	<b>Labor</b>				
5.0400	Ceramic Wall Tile Setting/Grouting	sq.m	30.72	712.23	21,879.55
14.0500	Ceramic Floor Tile Setting/Grouting	sq.m	43.59	712.23	31,045.89
	<b>Sub-total</b>				<b>153,305.44</b>
I	GENERAL REQUIREMENTS				<b>10,000.00</b>
II	DIRECT COST				<b>546,488.79</b>
III	INDIRECT COST 15% of (II)				<b>81,973.32</b>
IV	TAX 5% of (I + II)				<b>31,923.11</b>
V	<b>TOTAL CONSTRUCTION COST (I + II + III)</b>				<b>670,385.22</b>

Prepared by:

**CARL PAULO A. FERNANDO**

Engineer III - Education Facilities

Reviewed by:

**VICTORIA O. MADRIGAL**

Administrative Officer V

Recommending Approval:

**RAINELDA M. BLANCO, PhD**

Chief Education Supervisor - SGOD

Approved:

**CECILIA E. VALDERAMA PhD, CESO VI**

Assistant Schools Division Superintendent

Officer-in-Charge

Office of the Schools Division Superintendent



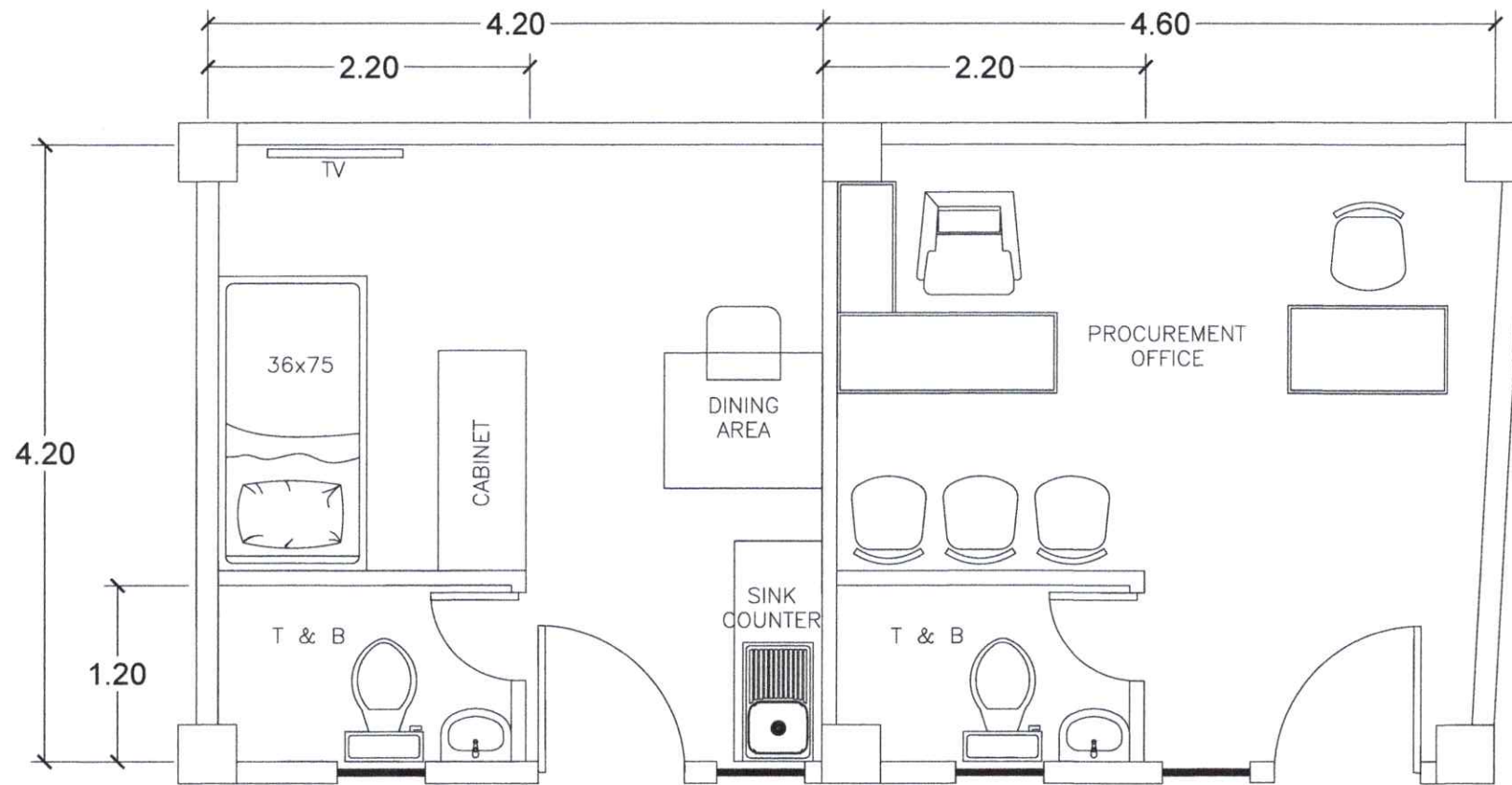

1  
A 1

GROUND FLOOR PLAN

SCALE NTS

PROJECT TITLE & LOCATION:	PREPARED BY:	REVIEWED BY:	RECOMMENDING APPROVAL:	APPROVED BY:	SHEET CONTENTS:	SHEET NO.:
<b>PROPOSED ASDS QUARTERS AND PROCUREMENT OFFICE</b> PROVINCIAL CAPITOL, MALOLOS CITY, BULACAN	CARL PAUL A. FERNANDO DIVISION ENGINEER	VICTORIA O. MADRIGAL ADMINISTRATIVE OFFICER V	RAINELDA M. BLANCO, PhD SGOOD CHIEF	CECILIA E. VALDERAMA, PhD, CESO VI ASSISTANT SCHOOLS DIVISION SUPERINTENDENT OFFICER-IN-CHARGE OFFICE OF THE SCHOOLS DIVISION SUPERINTENDENT	FLOOR PLAN	1 A 1